

# What is being proposed...from **ASHLAND TO CLARK?**

The proposal for Berteau from Ashland to Clark is a result of the community's concerns over vehicle speeding, cut through vehicle traffic, and wrong way bike and vehicle travel on this one-way section of Berteau. As a result, the treatments are designed to maintain a predictable average vehicle speed, discourage non-local traffic, and better define the roadway for all users.

## CONTRAFLOW BIKE LANES (RED ON MAP BELOW ●)

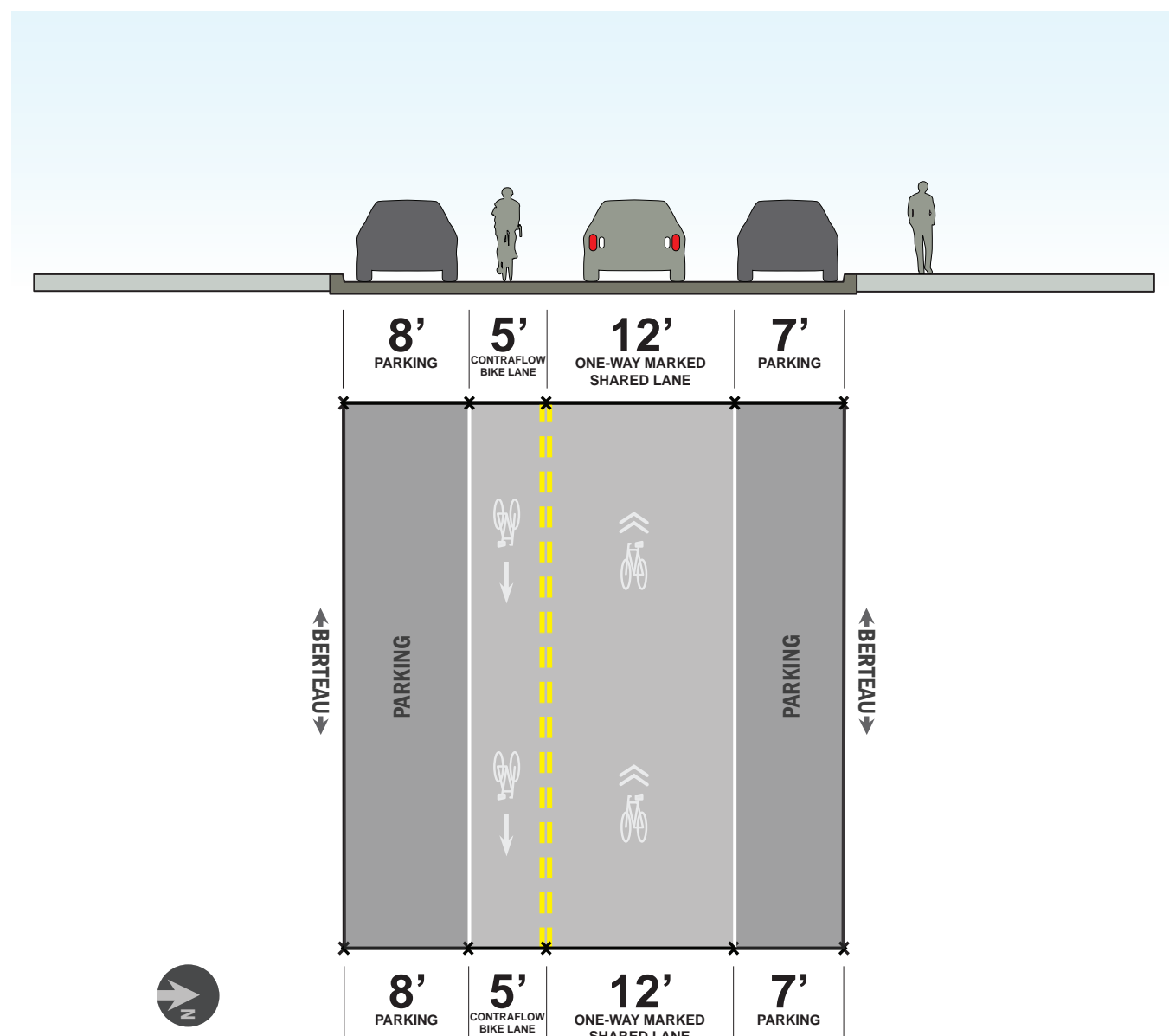

### Community Concerns:

- Vehicles speeding onto Berteau from Clark.
- Excessive non-local vehicle traffic.
- Wrong way bike traffic.

### Solution:

- A contraflow bike lane provides a dedicated space for eastbound bicycle traffic and a shared lane for westbound bicycle traffic.
- Re-allocating the existing roadway width results in safer average vehicle speeds and improved safety for all users.
- Slower average speeds discourage non-local drivers from using Berteau as a cut through route.

### Added Benefits:

- Safe and comfortable east-west connection to existing bike facilities on Clark St.
- Reduced pedestrian exposure to moving vehicles

### Parking Impacts:

- None

## TRAFFIC CIRCLE (ORANGE ON MAP BELOW ●)

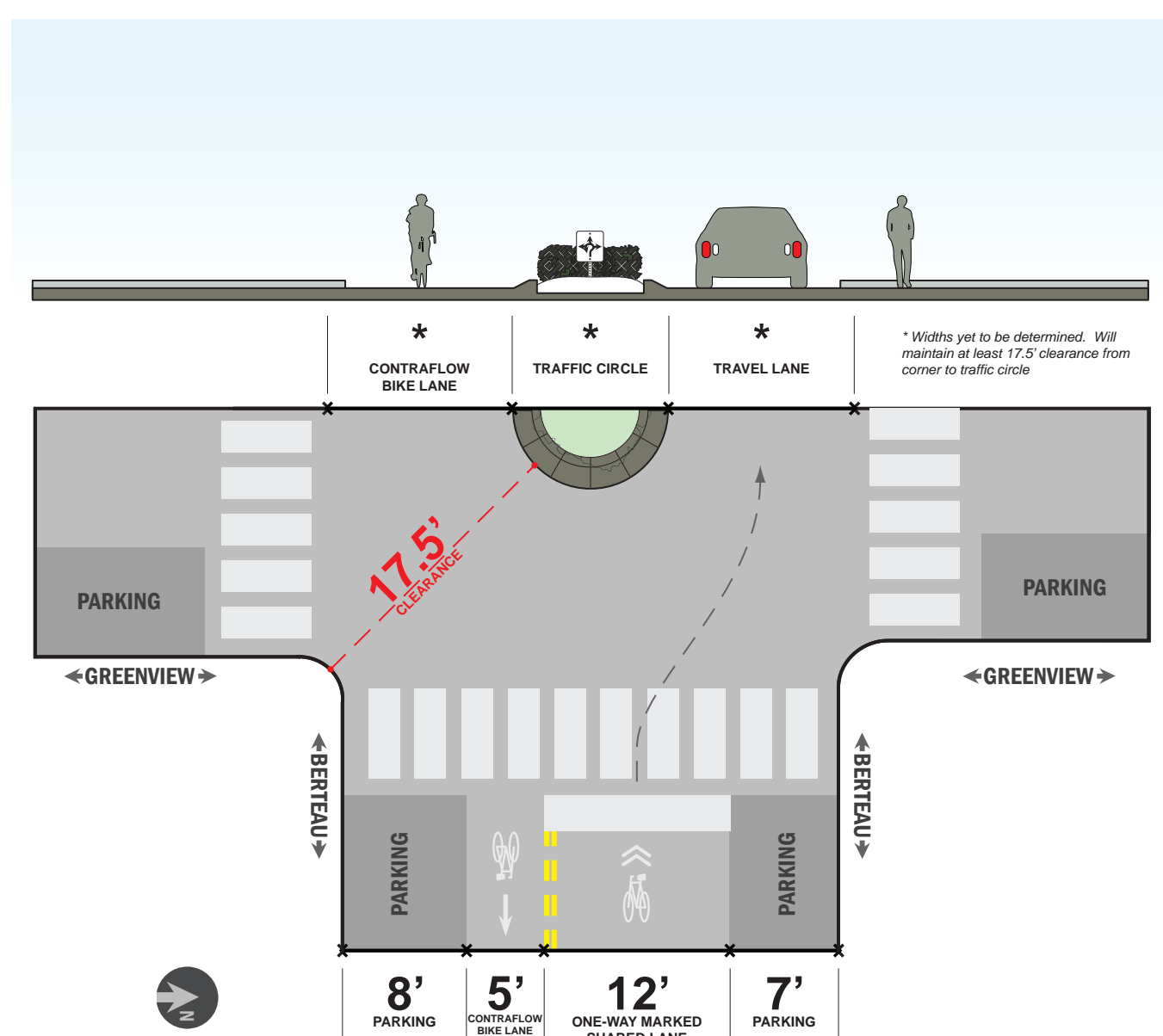

### Community Concerns:

- Vehicle speeding on Greenview.
- Excessive non-local vehicle traffic.
- Unwarranted stop sign.
- High number of pedestrians in the area.

### Solution:

- Remove westbound stop sign to prioritize travel on Berteau; maintain stop signs for Greenview traffic.
- According to the Institute of Transportation Engineers, traffic circles reduce vehicle speeds by an average of 4 mph and reduce volumes by 5%.
- Traffic circles require drivers to be more focused on the roadway and their surroundings.
- Designed for school buses, fire trucks, ambulances and large vehicles.

### Added Benefits:

- Can be planted/landscaped to improve neighborhood aesthetics.
- Reduced noise and pollution from stopped vehicles.
- Reduced mid-block speeding to make up for stopped time.

### Parking Impacts:

- None

## PEDESTRIAN REFUGE ISLAND (PURPLE ON MAP BELOW ●)

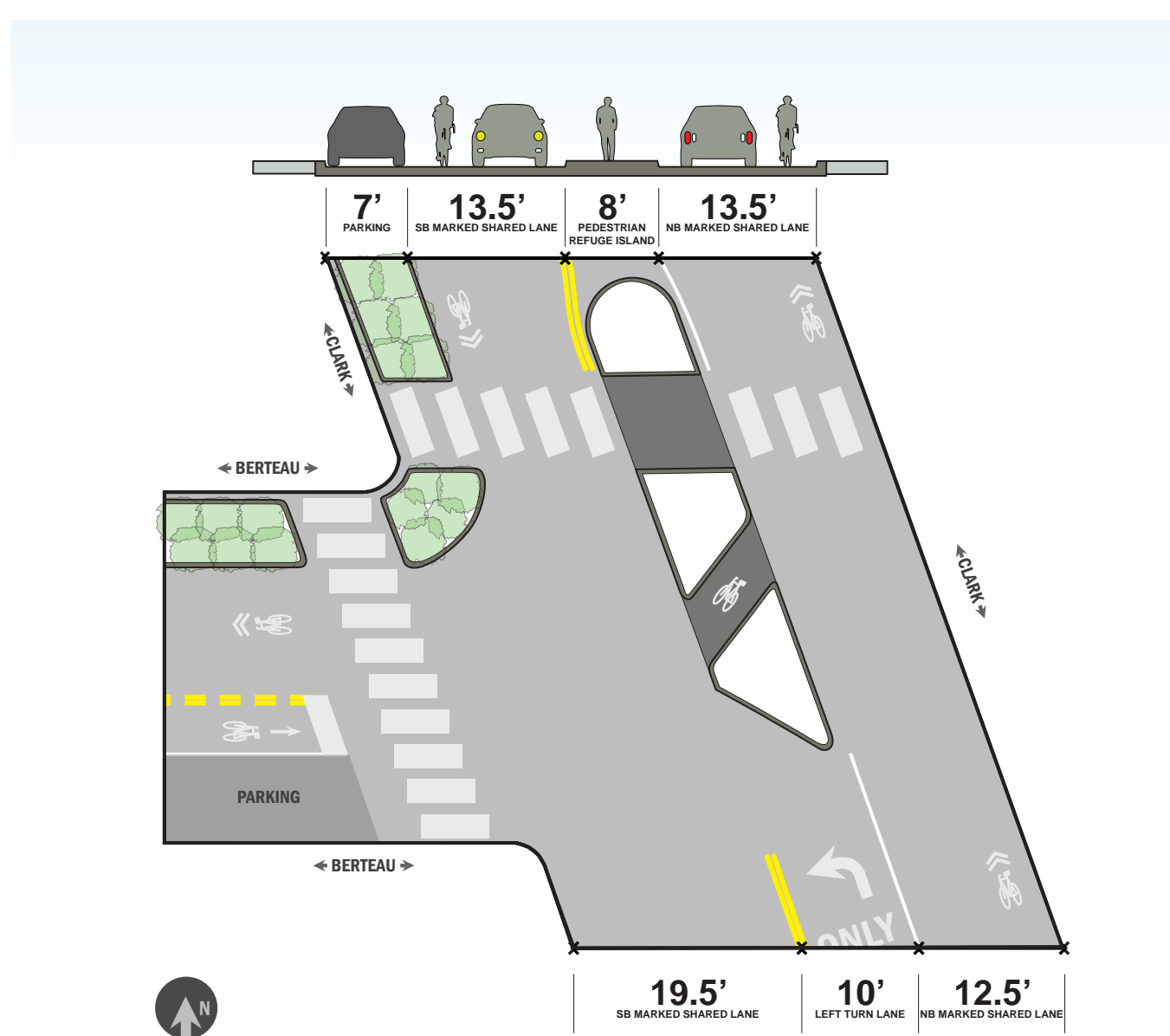

### Community Concerns:

- Vehicles speeding onto Berteau from Clark.
- Improve pedestrian safety in the neighborhood.
- Uncontrolled crosswalk - no signal, no striping.
- Unsafe turns onto Clark for bicycle traffic.

### Solution:

- Reduce exposed crossing distances for pedestrians.
- A pedestrian refuge island and curb extensions will reduce high speed vehicle turns onto Berteau.
- Refuge island will include a cut-through for bicycle traffic turning northbound onto Clark.
- Curb extensions will align vehicles away from the curb resulting in safer turns for bicycle traffic southbound onto Clark.

### Added Benefits:

- Enhanced visibility for pedestrians.
- Enhanced crosswalk.
- Physical protection for pedestrians crossing Clark.

### Parking Impacts:

- Loss of 5-6 spots on Clark



- ...Contraflow Lanes
- ...Traffic Circle
- ...Pedestrian Refuge Island
- ...Other Improvements